

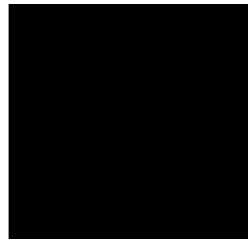

**For Lease**  
**Valley Centre Corporate Park**  
 2820 B Street NW, Building 1, Auburn

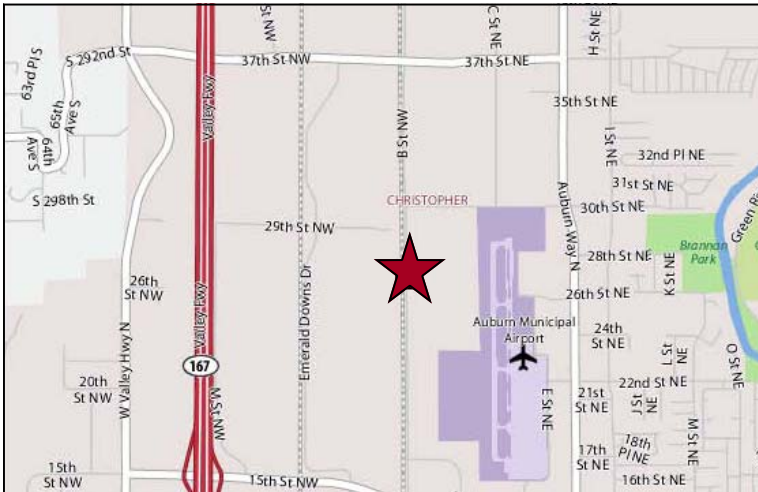

**Building Features**

- 63,000 SF Available
- 1,558 SF of Existing Office - Can Build More
- 18 DH Doors 9'x10'
- 1 GL Door
- 5 Dock Levelers
- 30' Clear Height
- Warehouse Fully Insulated
- Heavy Power
- Building Depth - 350'
- Column Spacing - 43'9"x60'
- \$0.34 PSF, NNN Warehouse
- \$0.75 - \$0.85 PSF, NNN Office
- NNN = \$0.09 PSF



Commercial Real Estate Services, Worldwide.

11235 SE 6th Street, Suite 130  
 Bellevue WA 98004  
 425 586 5600 phone  
 425 455 9138 fax  
 www.nai-psp.com

**For More Information Visit:**  
[www.nai-psp.com/properties/featured](http://www.nai-psp.com/properties/featured)

**Contact:**  
**Jeff Forsberg, CCIM**  
 direct 425 586 5610  
[jforsberg@nai-psp.com](mailto:jforsberg@nai-psp.com)

**Arie Salomon, SIOR, CCIM**  
 direct 425 586 5636  
[asalomon@nai-psp.com](mailto:asalomon@nai-psp.com)

The information contained herein has been given to us by the owner of the property or other sources we deem reliable, we have no reason to doubt its accuracy, but we do not guarantee it. All information should be verified prior to purchase or lease.  
 Valley Centre Corporate Park Bldg 1 JF 0219

